



Dockerty Health Care Services, a family owned and operated company, was founded by Don and Mary Dockerty in 1997. With the help of their children, Tim, Todd, and Tonya, there are now communities throughout Berrien County, Calhoun County, and Traverse City, MI.



8850 Red Arrow Hwy.
BRIDGMAN

6786 Red Arrow Hwy.
COLOMA

13 Longmeadow Dr.
NILES

168 Peace Blvd.
ST. JOSEPH



14420 Helmer Rd. South
BATTLE CREEK



14316 Helmer Rd. South
BATTLE CREEK



8774 N. 32nd St.
RICHLAND



1899 Dracka Rd.
TRAVERSE CITY



TRAVERSE MANOR

A Dockerty Family Senior Community

Living at Traverse Manor feels like being at home – where life feels right because everyone is part of a big family. Where the emphasis is always on creating a warm, comfortable environment, whether in the building and grounds, the decor, the good food, or in the genuine personal relationships that flourish. We're located in a beautiful country setting – peaceful and pleasant, yet close to town and a wealth of activities.

TRAVERSEMANOR.CARE



Lisa Crossley
Executive
Director



Amanda Gray
Office
Manager



Ashley Dilts
Administrative
Assistant



Aillin Stott
Kitchen
Manager

Tim Dockerty | Todd Dockerty
Owners

A DOCKERTY FAMILY SENIOR COMMUNITY

(231) 946-2999

1899 DRACKA ROAD • TRAVERSE CITY, MI 49685

IN TOUCH CARE

In Touch Care is a home care company that offers a range of personal care services to seniors who reside at Traverse Manor. Their rates are determined by the average amount of staff time needed to provide assistance to clients over a 24-hour period.

Items that will be considered in care, are:

- Reminders for meals and activities
- Assistance with eating
- Assistance with transfers
(When a resident requires two staff for a task, time is doubled)
- Assistance with activities of daily living
- Assistance with management of medication using designated pharmacy
- Nurse assistance with monthly injections and/or simple nursing procedures
- Daily weight, blood pressure, or blood sugar monitoring
- Assistance with toileting, management of incontinence issues
- Laundry services
- Behavioral issues involving staff interventions, i.e. significant personality changes

RENT AND LEVEL OF CARE SUMMARY

Apartment	Base Rent	Assisted Living Unit	Pavel Staffing
Studio-Deluxe	\$3,495	Up to .5/hr	\$2,695
1 BR w/Window	\$3,695	Up to 1/hr	\$3,095
1 BR w/Patio	\$3,845	Up to 1.5/hr	\$3,495
1 BR Deluxe	\$3,995	Up to 2/hr	\$3,895
Second Person	\$1,200/month		

Now Offering Memory Care!

Apartment All-Inclusive Price

Studio \$6,895

FEES

Move-In Fee (non-refundable)	\$1,500	Cable Box & Remote Replacement	\$250
Medication Mgmt. Fee (In-House Pharmacy)	\$195	Pendant Replacement	\$150
Medication Mgmt. Fee (Outside Pharmacy)	\$695		
Room Tray Fee (More than 5 room trays/month)	\$300		

SERVICES & AMENITIES

- Spacious studio apartments with private bath and shared patio.
- Spacious one-bedroom apartments with fully equipped kitchen and sliding door to private patio.
- Phone, cable and internet services included.
- Three delicious home cooked meals daily.
- Four complimentary family/guest meals included each month.
- Pendant-style nurse call button is offered to residents to alert staff when/who needs assistance.
- Free laundry facilities are available for resident use.
- All-inclusive utilities
- Lawn maintenance
- Snow Removal

The following services are provided on-site by sources outside of Traverse Manor:

- Podiatrist
- Home Care Services
- Skilled Home Care
- Physician/Nurse Practitioner
- Pharmacy
- Hospice Services

STUDIO APPROX. 228 SQ. FT.

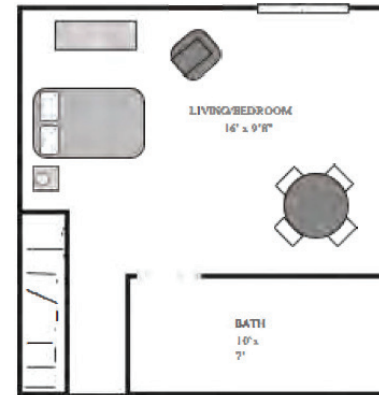

ONE BEDROOM APPROX. 576 SQ. FT.

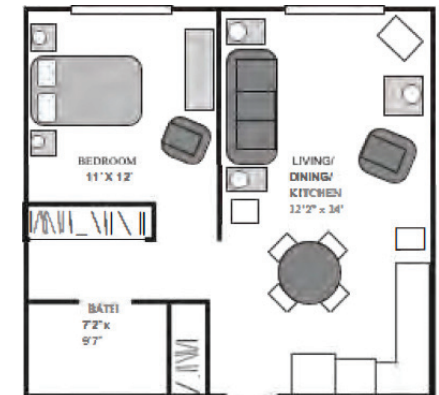

* Room layouts are examples - actual rooms may have a different layout.